

Plan Of Building Of BABA BANDA SINGH BAHADUR PUBLIC SCHOOL Site. At Samana Patiala Road,  
 Vill. Fatehpur Teh.Samana Distt. Patiala (PUNJAB)

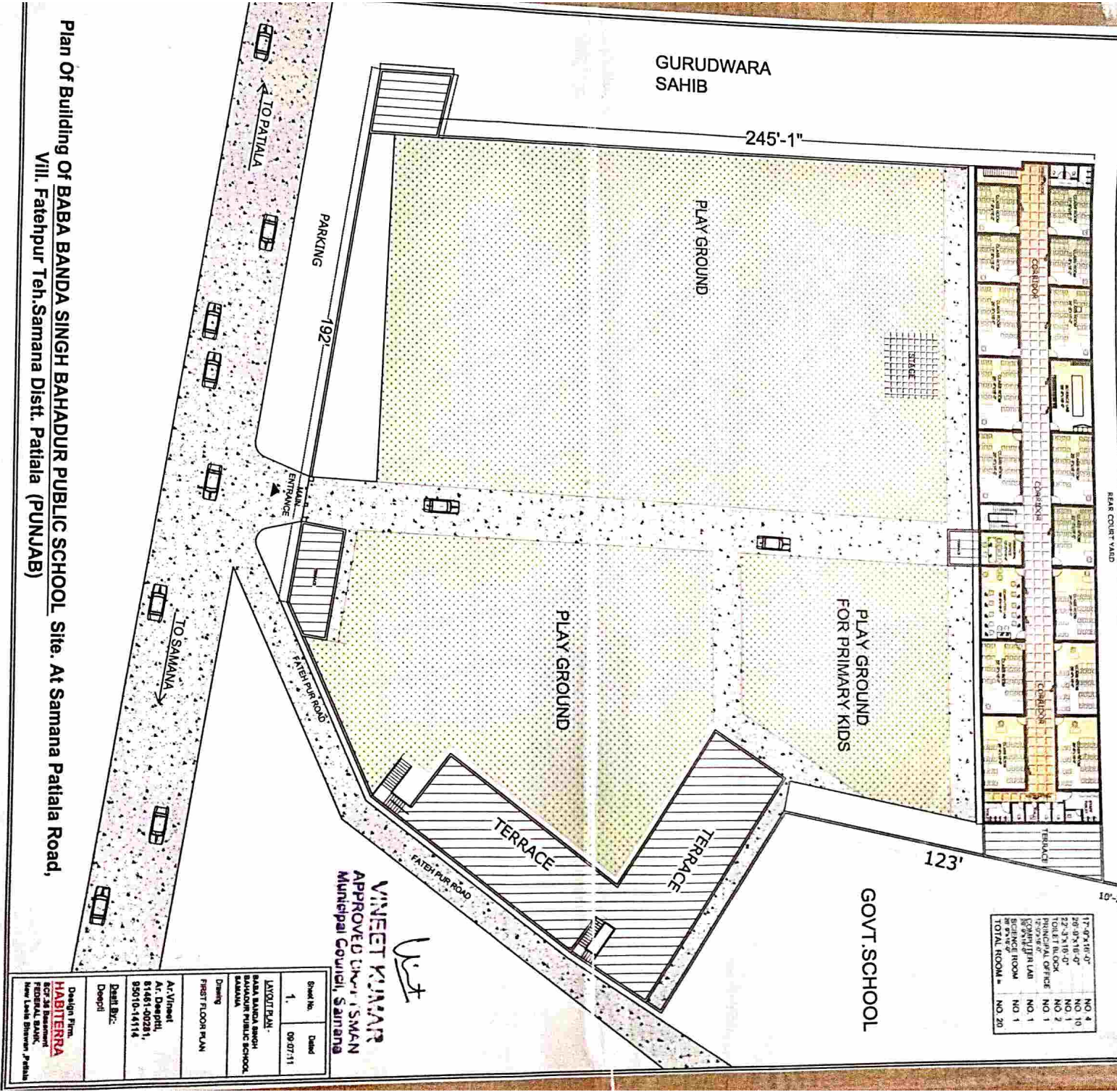

NO 4	17'-0\" x 16'-0"
NO 10	20'-0\" x 18'-0"
NO 1	TOILET BLOCK
NO 2	PRINCIPAL OFFICE
NO 1	TEACHERS ROOM
NO 1	SCIENCE LAB
NO 1	SCIENCE ROOM
NO 20	TOTAL ROOMS =

**VINEET KUMAR**  
 APPROVED ARCHT. SMAN  
 Municipal Council, Samana

Sheet No.	Date
1.	09/07/11

DATE/OUT/DRAWN:  
 BABA BANDA SINGH  
 BAHADUR PUBLIC SCHOOL  
 SAMANA

DESIGNER:  
 A.V. Vineet  
 AT. Deepthi  
 81461-00281,  
 85010-14114

DRAWN BY:  
 Deepthi

Design Firm:  
**HABITERRA**  
 8C7-26 Basement  
 FEDERAL BANK,  
 New Laha Drive, Patiala



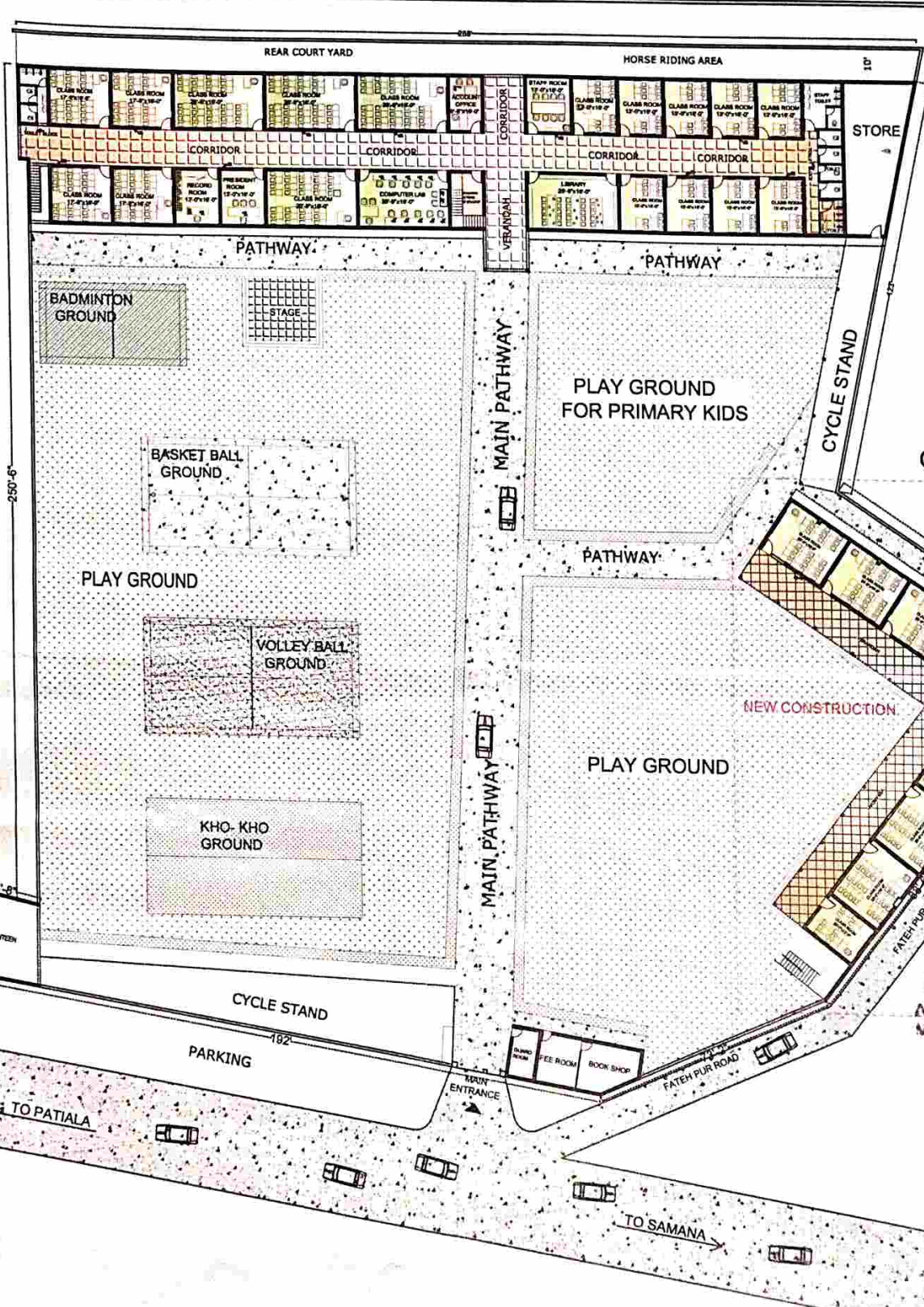

17'-0"x18'-0"	NO. 4
26'-0"x16'-0"	NO. 4
13'-0"x16'-0"	NO. 9
20'-0"x16'-0"	NO. 4
20'-0"x16'-6"	NO. 3
12'-0"x20'-0"	NO. 1
TOILET BLOCK	NO. 3
STORE	NO. 1
FEE ROOM	NO. 1
BOOK SHOP	NO. 1
CANTEEN	NO. 1
GAURD ROOM	NO. 1
ACCOUNT OFFICE	NO. 1
STAFF ROOM	NO. 1
RECORD ROOM	NO. 1
LIBRARY	NO. 1
COMPUTER LAB	NO. 1
PRESIDENT ROOM	NO. 1
TOTAL ROOM =	NO. 39

TOTAL AREA = 7,89,080 Sq.ft.  
COVERED AREA = 18,838 Sq.ft.  
OPEN AREA = 78,8242 Sq.ft.

GURUDWARA SAHIB

GOVT. SCHOOL

VINEET KUMAR  
APPROVED DRAFTSMAN  
Municipal Council, Samana

Sheet No.	Dated
1.	09.07.11
LAYOUT PLAN - BABA BANDA SINGH BAHADUR PUBLIC SCHOOL SAMANA	
Drawing GROUND FLOOR PLAN	
Ar. Vineet Ar. Deepthi, 81461-00281, 95010-14114	
Drawn By:- Deepthi	
Design Firm. <b>HABITERRA</b> 9CF 36 Basement FEDERAL BANK, New Looka Bhawan, Patiala	

Plan Of Building Of **BABA BANDA SINGH BAHADUR PUBLIC SCHOOL** Site. At Samana Patiala Road, VIII. Fatehpur Teh.Samana Distt. Patiala (PUNJAB)